

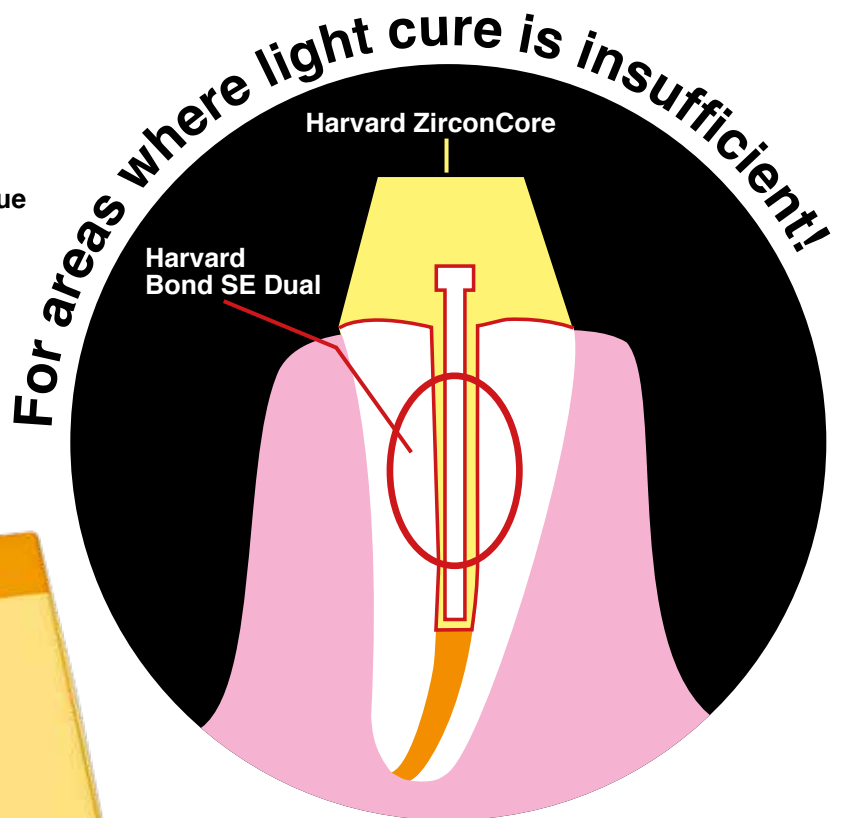

Harvard Bond SE Dual

Dual-curing self-etching two components adhesive – 1 Step

- Etching, priming and bonding after mixing in one step
- Only one layer necessary
- Strong and long-lasting adhesion to enamel and dentin
- Hydrophilic for the Wet-Bonding technique
- Dual cure for application especially with self and dual cure composites like Harvard ZirconCore



With or
without
light cure
in only one
step!



Shear bond strength of selected bonding systems on dentin / enamel

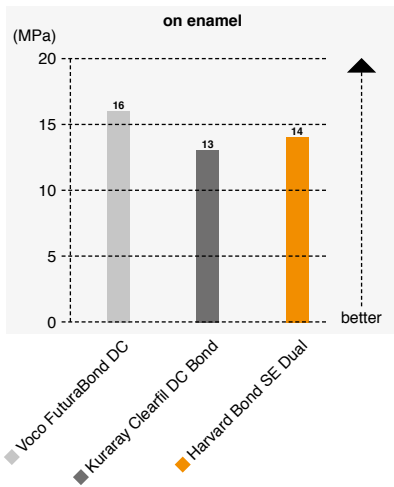
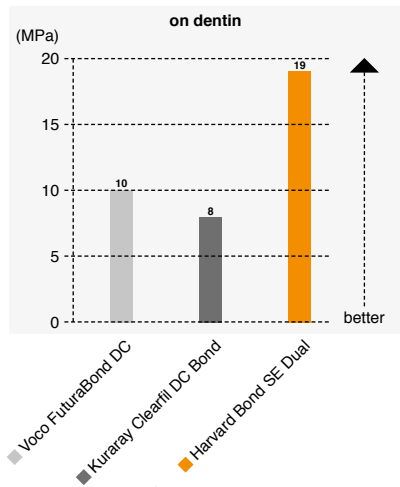

1892
seit
HARVARD®



We recommend **Harvard ZirconCore** dual cure core build-up and post cementation composite



With polymerisation excellent shear bond strenght on enamel and dentin.

Application

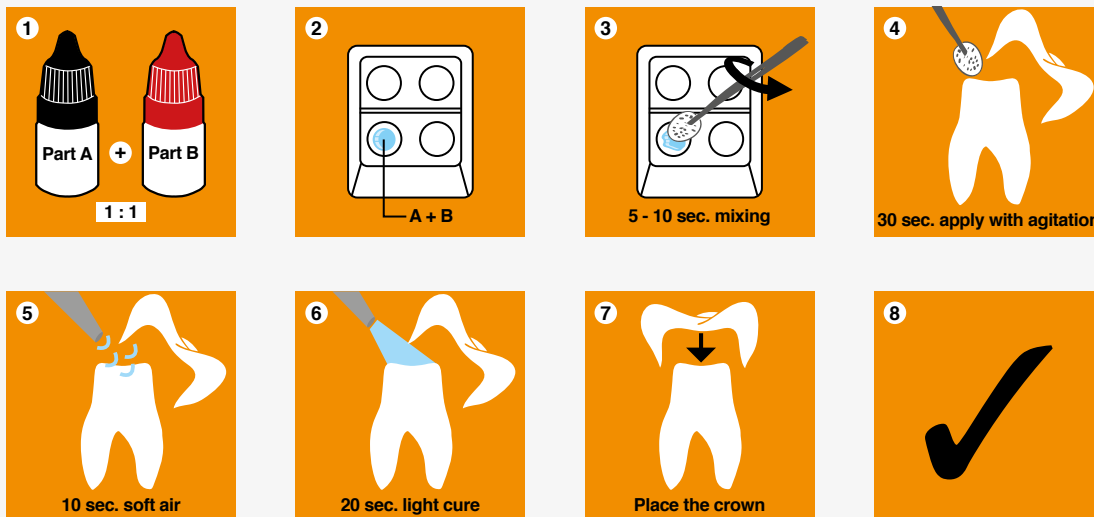

Article information

	Order no.		Order no.
Harvard Bond SE Dual 2 x 5 ml bottle, 50 Microbrush®, 5 mixing wells	7083602	Harvard ZirconCore 5 ml minimix syringe, 10 mixing tips, 10 intra tips long, in the shade A3	7083600
Harvard Bond SE Dual Refill 2 x 5 ml bottle	7083605	Harvard Mini 1:1 O-Brown refill bag with 50 mixing tips	7083610
		Harvard IntraTips long refill bag with 50 intra tips long	7083620

Liability is excluded for all printing errors and omissions. Before using our Harvard products, the respective directions for use should be noticed in every case. All measurements are internal measurements of Harvard Dental International.

Harvard Distribution Partner.



HARVARD®

Marke und Qualität seit 1892

Harvard Dental International GmbH
Margaretenstr. 2 - 4, 15366 Hoppegarten, Germany
Phone: + 49 (0) 30/99 28 978-0
Fax: + 49 (0) 30/99 28 978-19
info@harvard-dental-international.de

10517_EN_11/18

www.harvard-dental.de