



Harvard InterLock®

Very strong, self-etch, light cure bonding

Harvard InterLock® provides excellent adhesion to enamel and dentin. It is also extremely reliable. A quick and easy application with excellent sealing is possible at any time.

- High and even bond strength
- Extremely reliable
- Easy and fast application
- Excellent seal
- Not technique and moisture sensitive
- Long-term and safe adhesion to enamel and dentin
- Hydrophilic for wet bonding technique

Extremely reliable in just two steps.

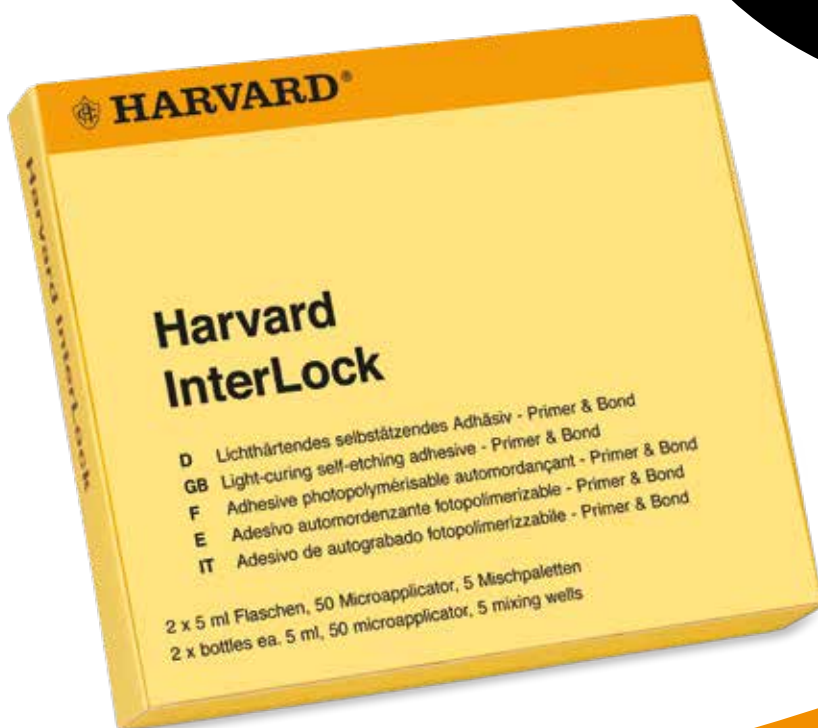

Physical Properties

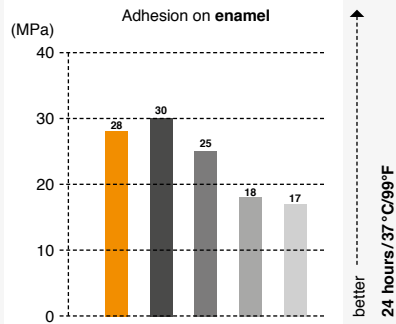
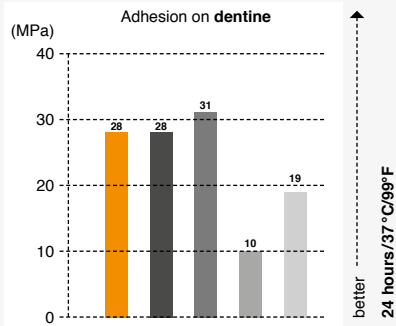

- Harvard InterLock®
- Clearfil SE Bond (Kuraray)
- Optibond XTR (Kerr)
- AdheSe (Ivoclar Vivadent)
- One Coat Self-Etching Bond (Coltene)

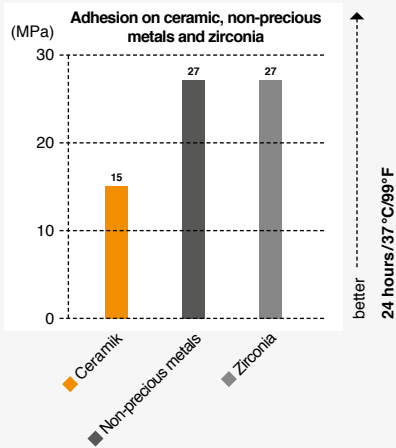

Application

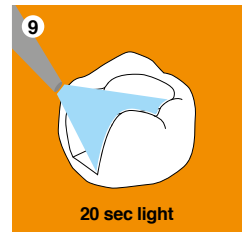
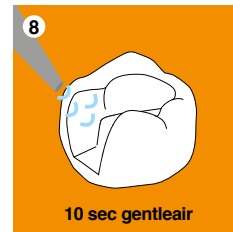
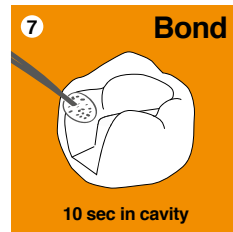
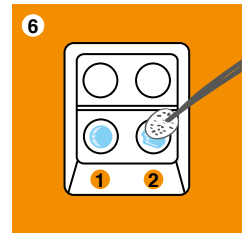
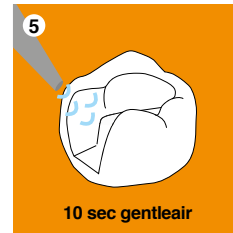
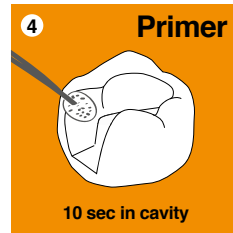
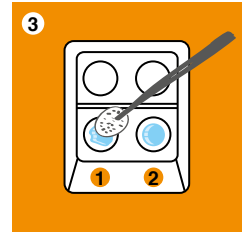
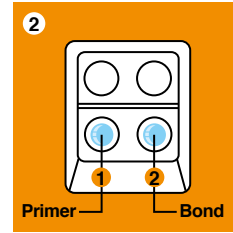
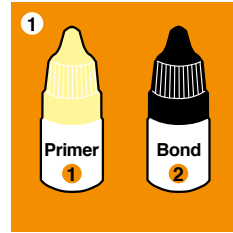

Very good Marginal Adaptation

Before and after Fatigue Simulation

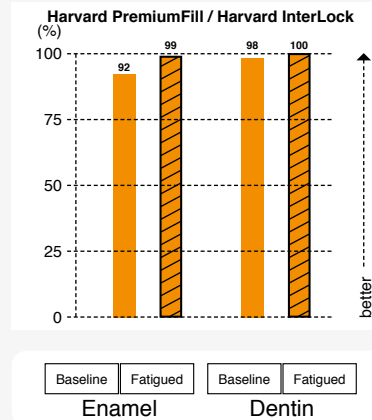

Prof. Dr. K. H. Kunzelmann; Dr. I. Nyamaa, University of Munich, Germany, 2016



Technical Data

Shear bond strength on Enamel / Dentin 28 MPa
 Shear bond strength on Silicate ceramics 15 MPa
 Shear bond strength to Zirconia 27 MPa
 Shear bond strength to non-precious metal 27 MPa

Article information

Harvard InterLock®
 2x5 ml bottle, 50 Microbrush®,
 5 5 mixing wells
Microbrush®
 refill bag with 50 applicators

Order-no.

7083603
 7095156

Liability is excluded for all printing errors and omissions. Before using our Harvard products, the respective directions for use should be noticed in every case. All measurements are internal measurements of Harvard Dental International.

Harvard Distribution Partner.



HARVARD®

Marke und Qualität seit 1892

Harvard Dental International GmbH
 Margaretenstr. 2 - 4, 15366 Hoppegarten, Germany
 Phone: + 49 (0) 30/99 28 978-0
 Fax: + 49 (0) 30/99 28 978-19
 info@harvard-dental-international.de